

Волоконно-оптические световоды KL и аксессуары

Технические характеристики

По вопросам продаж и поддержки обращайтесь:

Алматы (727)345-47-04
Ангарск (3955)60-70-56
Архангельск (8182)63-90-72
Астрахань (8512)99-46-04
Барнаул (3852)73-04-60
Белгород (4722)40-23-64
Благовещенск (4162)22-76-07
Брянск (4832)59-03-52
Владивосток (423)249-28-31
Владикавказ (8672)28-90-48
Владимир (4922)49-43-18
Волгоград (844)278-03-48
Вологда (8172)26-41-59
Воронеж (473)204-51-73
Екатеринбург (343)384-55-89

Иваново (4932)77-34-06
Ижевск (3412)26-03-58
Иркутск (395)279-98-46
Казань (843)206-01-48
Калининград (4012)72-03-81
Калуга (4842)92-23-67
Кемерово (3842)65-04-62
Киров (8332)68-02-04
Коломна (4966)23-41-49
Кострома (4942)77-07-48
Краснодар (861)203-40-90
Красноярск (391)204-63-61
Курск (4712)77-13-04
Курган (3522)50-90-47
Липецк (4742)52-20-81

Магнитогорск (3519)55-03-13
Москва (495)268-04-70
Мурманск (8152)59-64-93
Набережные Челны (8552)20-53-41
Нижний Новгород (831)429-08-12
Новокузнецк (3843)20-46-81
Ноябрьск (3496)41-32-12
Новосибирск (383)227-86-73
Омск (3812)21-46-40
Орел (4862)44-53-42
Оренбург (3532)37-68-04
Пенза (8412)22-31-16
Петрозаводск (8142)55-98-37
Псков (8112)59-10-37
Пермь (342)205-81-47

Ростов-на-Дону (863)308-18-15
Рязань (4912)46-61-64
Самара (846)206-03-16
Санкт-Петербург (812)309-46-40
Саратов (845)249-38-78
Севастополь (8692)22-31-93
Саранск (8342)22-96-24
Симферополь (3652)67-13-56
Смоленск (4812)29-41-54
Сочи (862)225-72-31
Ставрополь (8652)20-65-13
Сургут (3462)77-98-35
Сыктывкар (8212)25-95-17
Тамбов (4752)50-40-97
Тверь (4822)63-31-35

Тольятти (8482)63-91-07
Томск (3822)98-41-53
Тула (4872)33-79-87
Тюмень (3452)66-21-18
Ульяновск (8422)24-23-59
Улан-Удэ (3012)59-97-51
Уфа (347)229-48-12
Хабаровск (4212)92-98-04
Чебоксары (8352)28-53-07
Челябинск (351)202-03-61
Череповец (8202)49-02-64
Чита (3022)38-34-83
Якутск (4112)23-90-97
Ярославль (4852)69-52-93

Россия +7(495)268-04-70

Казахстан +(727)345-47-04

Беларусь +(375)257-127-884

Узбекистан +998(71)205-18-59

Киргизия +996(312)96-26-47

эл.почта: sqh@nt-rt.ru || сайт: <https://schott.nt-rt.ru/>

KL Gooseneck Light Guides

for KL Light Sources



These are flex and stay light guides that remain in place after positioning, providing flexible and obedient incident illumination for space-constrained applications.

Features:

- Available with one, two or three branches.
- Available as 2-branch Gooseneck plus flexible branch (Combi Light Guide).
- Focusing optics and filter accessories available.
- High white light transmission thanks to the use of SCHOTT PURAVIS® fibers.

Advantages:

- Perfect trade-off between flexibility and mechanical stability.
- Mechanical stability enables long-term usability and precise positioning for complete control of light placement.
- The Combi Light Guide can be fixed stationary at the microscope post.

Types and compatibility

Type	Compatible cold light source	Part No.	Length	End tip Ø	End tip length	Active Ø branch	Active Common end Ø	Outer Ø Jacketing	Light source adapter Ø
			(L)	(E)	(l)	(b)	(B)	(D)	(F)
1- branch	KL 300 LED	170.101	500 mm 19.69"	6 mm 0.24"	20 mm 0.79"	3.5 mm 0.14"	5 mm 0.20"	11 mm 0.43"	9 mm 0.35"
	KL 1600 LED KL 2500 LED KL 1500 HAL	154.101	600 mm 23.62"	6 mm 0.24"	20 mm 0.79"	4.5 mm 0.18"	4.5 mm 0.18"	11 mm 0.43"	10 mm 0.39"
2- branch	KL 300 LED	170.202	500 mm 19.69"	6 mm 0.24"	20 mm 0.79"	3.5 mm 0.14"	5 mm 0.20"	11 mm 0.43"	9 mm 0.35"
	KL 1600 LED KL 2500 LED KL 1500 HAL	154.202	600 mm 23.62"	6 mm 0.24"	20 mm 0.79"	4.5 mm 0.18"	6.4 mm 0.26"	11 mm 0.43"	10 mm 0.39"
3- branch	KL 1600 LED KL 2500 LED KL 1500 HAL	154.302	600 mm 23.62"	6 mm 0.24"	20 mm 0.79"	4.5 mm 0.18"	7.8 mm 0.31"	11 mm 0.43"	10 mm 0.39"
Combi Light guide: 2-branch Gooseneck and 1-branch Flexible Light Guide	KL 300 LED KL 1600 LED KL 2500 LED KL 1500 HAL	170.402	(L) 500 mm 19.69" (L*) 800 mm 31.50"	6 mm 0.24"	20 mm 0.79"	4.5 mm 0.18"	6.4 mm 0.26" randomized	(D) 11 mm 0.43" (D*) 14 mm 0.55"	9 mm 0.35" and 10 mm 0.39"

For compatibility with discontinued SCHOTT light sources and third party products, please contact us.

We provide a variety of optical and mechanical accessories for our KL light guides. For details please refer to our system diagrams or according datasheets.

Dimensions

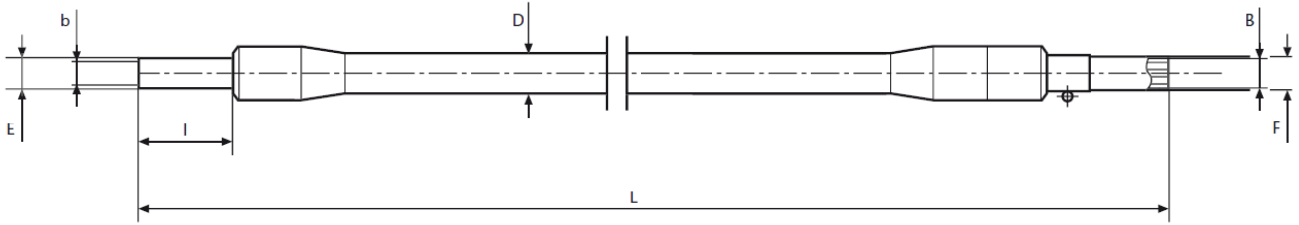

1-branch

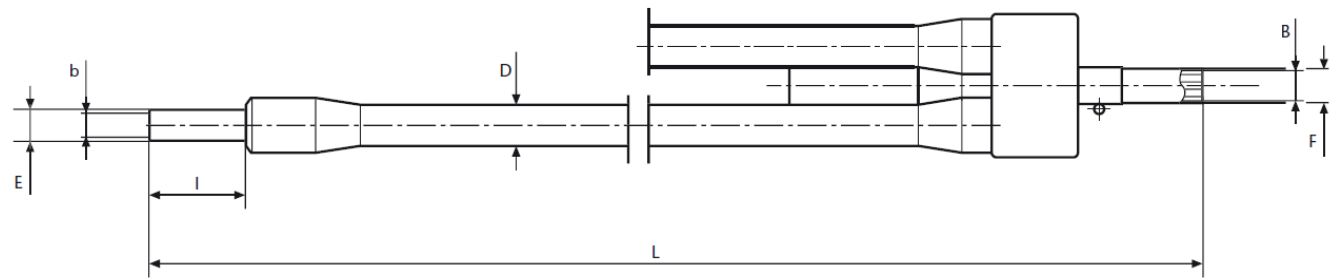

2- and 3-branch

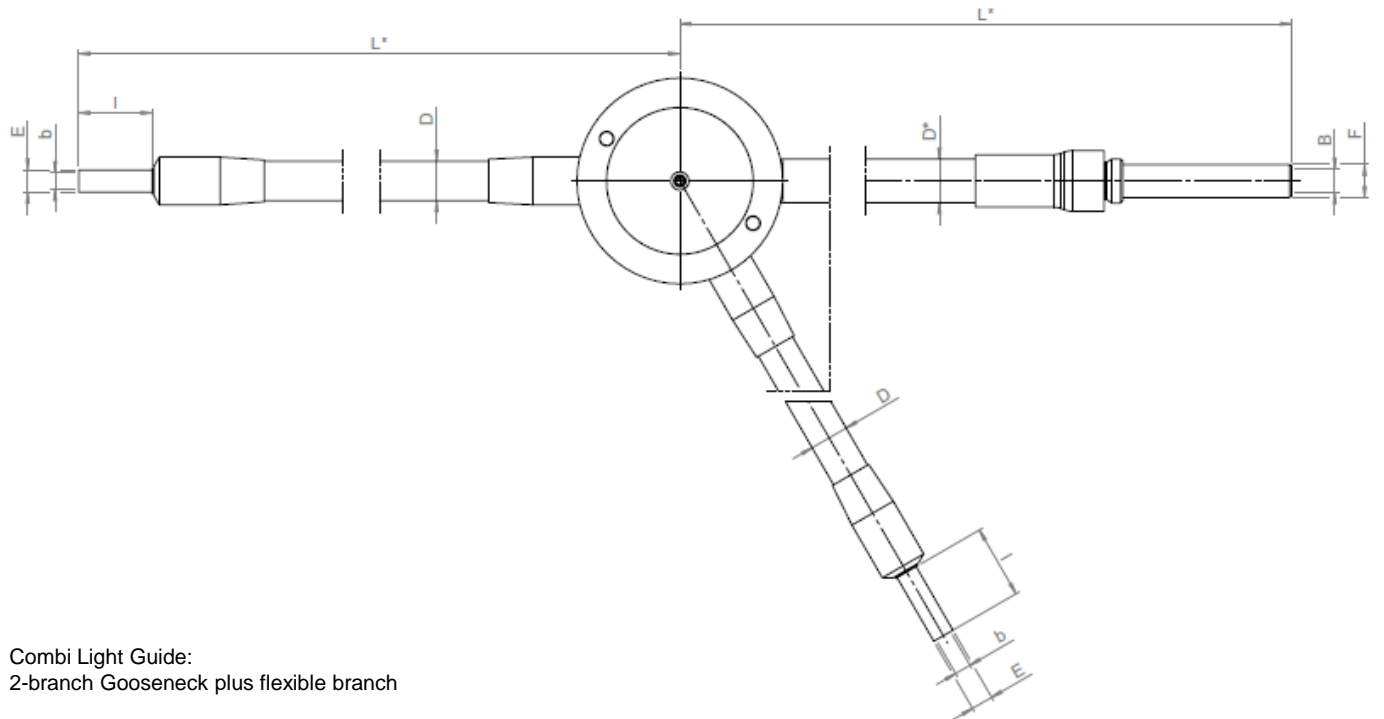

Combi Light Guide:
2-branch Gooseneck plus flexible branch

Pictures are provided for illustration purposes only, and may not provide an accurate reflection of the actual product.

KL Accessories

Accessories for KL Light Sources



SCHOTT offers a variety of mechanical and optical accessories to increase the flexibility of its KL Light Sources. They include color filters, mounting brackets and electrical accessories such as a footswitch.

Features:

- Daylight and halogen filters available.
- Color filters available in red, blue, green and yellow.
- Mounting brackets for column Ø from 20 – 35 mm.
- Power cords strictly according to international standards.
- Footswitch for remote operations.

Advantages:

- Compatible with a wide variety of OEM designs.
- Color filters with high transmission and unaffected by light-entrance angle.
- Additional contrast available with a range of filters.
- Mechanically designed for easy handling.

Accessories	Compatible Products	Characteristics	Part No.
Base	KL 300 LED		158.340
Mounting Bracket for Base	KL 300 LED		120.250
Mounting Bracket for Column		For Column Ø 20 mm (0.78")	120.220
		For Column Ø 25 mm (0.98")	120.225
		For Column Ø 29 mm (1.14")	120.229
		For Column Ø 32 mm (1.26")	120.232
		For Column Ø 35 mm (1.38")	120.235
		For ZEISS stand K, Stand M	120.240
Light Guide Adapter	KL 1600 LED KL 2500 LED	For Megalight by SCHOTT Nippon K.K.	158.321
		For ColdVision by SCHOTT North America	158.322
	KL 1500 HAL	For Volpi and Photonic	158.323
		For Volpi and Photonic	158.320
Filter Holder	KL 1500 HAL KL 1600 LED KL 2500 LED	Empty holder for insert filter Ø 28 mm (1.10")	258.330
Insert filter Ø 28 mm	KL 1500 HAL KL 1600 LED KL 2500 LED	Blue	258.302
		Red	258.303
		Green	258.304
		Yellow	258.305
	KL 1500 HAL	Daylight	258.306
	KL 1600 LED KL 2500 LED	Halogen	258.307
	KL 2500 LED	For fluorescence excitation blue $\lambda = 450$ nm	258.313
		For fluorescence excitation green $\lambda = 540$ nm	258.314
Power cord 1.8 m	KL 1500 HAL KL 1600 LED KL 2500 LED	EU Plug: IEC-C13 to CEE 7/7	400.051
		US Plug: IEC-C13 to NEMA 5-15	400.052
		UK Plug: IEC-C13 to BS 1363	400.053
		Swiss Plug: IEC-C13 to SEV1011	400.054
Footswitch	KL 2500 LED	Momentary	400.020

Mechanical Accessories for KL Light Guides



SCHOTT offers a variety of mechanical accessories to precisely position its KL Light Guides at the required point. Accessories include an articulated arm and base, as well as holders for different size light guides, focusing lenses and adapters for ring lights.

Features:

- Stable design
- Easy handling
- Adapter for different lens sizes available

Advantages:

- Precise positioning of light guides
- Compatible with different OEM designs

Types

Accessories	Compatible Products	Characteristics	Part No.	
Holder	For Annular Ring Lights	1x M6 thread	157.430	
	For Flexible Light Guides	Ø up to 5.0 mm (0.20")	1x M6 thread	158.330
		Ø 8.0 mm + 9.0 mm (0.31" + 0.35")	1x M6 thread	158.335
		Ø 12.0 + 15.0 mm (0.47" + 0.59")	3x M6 threads	157.430
	For Focusing Lenses	Ø up to 5.0 mm (0.20")		158.341
Ø 8.0 mm (0.31")			157.430	
Articulated Arm	For Line Lights, Ring Lights & Flexible Light Guides	200 mm (7.87") length / 2x M6 threads	158.345	
Base	For Articulated Arm	Ø 100 mm (3.94") / 3x M6 holes	158.340	
Adapter	For Combi Light Guide	For Ø 32 mm (1.26") column	158.402	
	For Brightfield Ring Lights	Ø 66 mm (2.60")	ID Ø 50 mm to OD Ø 66 mm (1.97" to 2.60")	157.448
			ID Ø 58 mm to OD Ø 66 mm (2.28" to 2.60")	157.450
			ID Ø 60 mm to OD Ø 66 mm (2.36" to 2.60")	157.452
	For Darkfield Ring Lights	Ø 66 mm (2.60")	Working distance 30 to 50 mm (1.18" to 1.97")	157.569
			Working distance 50 to 80 mm (1.97" to 3.15")	157.567
			Working distance 80 to 110 mm (3.15" to 4.33")	157.562
	For Transmitted Light Stage	Ø 84 mm	For Base Plate Ø 90 mm (3.54")	157.630
			For Base Plate Ø 100 mm (3.94")	157.600
			For Base Plate Ø 120 mm (4.72")	157.610
For Base Plate Ø 180 mm (7.09")			157.620	

Optical Accessories for KL Light Guides



SCHOTT provides a wide range of optical accessories to increase the flexibility of its products, which includes Transmitted Light Stages for backlight illumination, focusing lenses, as well as a large number of filters.

Features:

- Focusing lenses can increase light intensity at the spot center by a factor of three.
- Cost-effective transmitted brightfield illumination.
- Additional contrast can be achieved using a variety of filters.

Advantages:

- Compatible with different OEM designs.
- Polarization filters have the optimal extinction ratio.
- Color filters exhibit high transmission rates and remain unaffected by light entrance angle.

Types

Accessories	Compatible Product		Characteristics	Part No.
Transmitted Light Stage	Flexible Light Guides	Ø up to 5.0 mm (0.20")	Ø 84 mm (3.31")	122.150
Diffuse Face Light	Flexible Light Guides	Ø 8.0 mm + 9.0 mm (0.31" + 0.35")	Active area 78 x 30 mm (3.07" x 1.18")	500.100
Focusing Lens	Flexible Light Guides & Gooseneck	Ø up to 5.0 mm (0.20")	with colour filter set: red, blue, green, yellow	158.210
	Flexible Light Guides	Ø 8.0 mm + 9.0 mm (0.31" + 0.35")		158.200
Analyzer*	Transmitted Light Stage	with Polarization Filter	M 49 x 0.75	158.215
			M 52 x 1.0	158.505
Polarization Filter	Transmitted Light Stage		Ø 84 mm (3.31")	158.500
	Annular Ring Light		Ø 66 mm (2.60")	158.430
	Focusing Lens	Ø up to 5.0 mm (0.20")	Twistable	158.205
Ø 8.0 mm + 9.0 mm (0.31" + 0.35")		Twistable	158.206	
Daylight Filter	Focusing Lens	Ø up to 5.0 mm (0.20")		158.211
Halogen Filter				158.207

* Analyzer for specific objective types may need to be purchased from the accessory range of the microscope/objective vendor

Dimensions – Accessories for KL Light Sources

Base

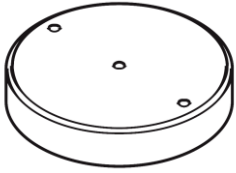

P/N: 158.340

Mounting bracket for base

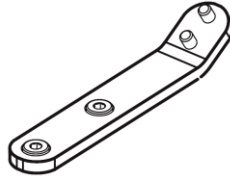

P/N: 120.250

Mounting bracket for column

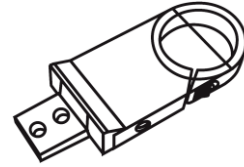

P/N: 120.220 | 120.225 | 120.229 |
120.232 | 120.235 | 120.240

Filter Holder

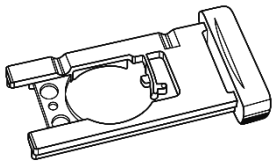

P/N: 258.330

Insert Filter



P/N: 258.302 | 258.303 | 258.304 |
258.305 | 258.306 | 258.307 |
258.313 | 258.314

Power Cord

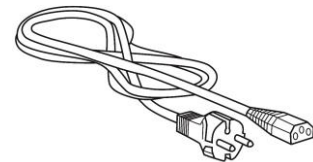

P/N: 400.051 | 400.052 | 400.053 |
400.054

Footswitch

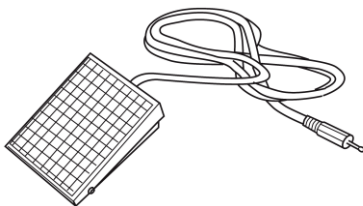

P/N: 400.020

Light Guide Adapter

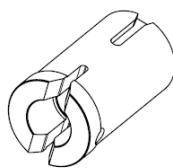

P/N: 158.321 | 158.322 | 158.323 |
158.320

Pictures are provided for illustration purposes only, and may not provide an accurate reflection of the actual product.

Dimensions – Mechanical Accessories for KL Light Guides

Holder

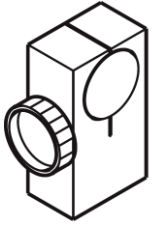

P/N: 157.430

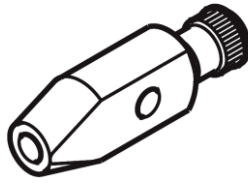

P/N: 158.330 | 158.335

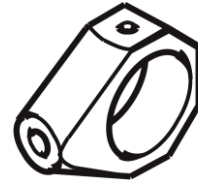

P/N: 158.341

Articulated arm and base

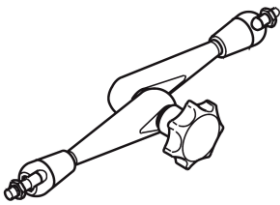

P/N: 158.345

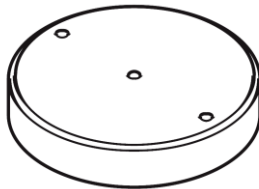

P/N: 158.340

Adapter

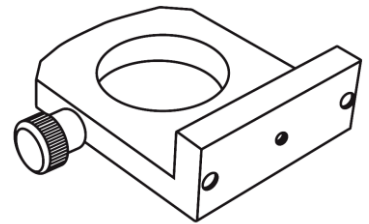

P/N: 158.402

Adapter

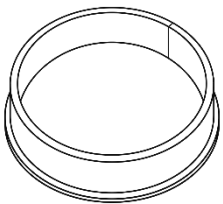

P/N: 157.448 | 157.450 | 157.452

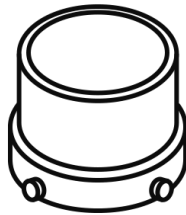

P/N: 157.569 | 157.567 |
157.562

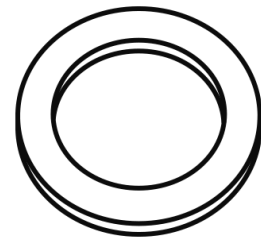

P/N: 157.630 | 157.600 |
157.610 | 157.620

Pictures are provided for illustration purposes only, and may not provide an accurate reflection of the actual product.

Dimensions – Optical Accessories for KL Light Guides

Transmitted Light Stage

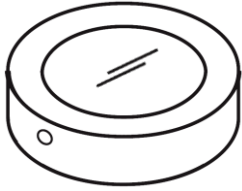

P/N: 122.150

Diffuse Facelight

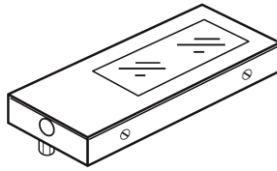

P/N: 500.100

Focusing Lens

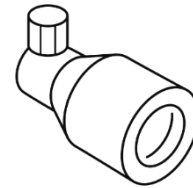

P/N: 158.210 | 158.215

Focusing Lens with filter Set

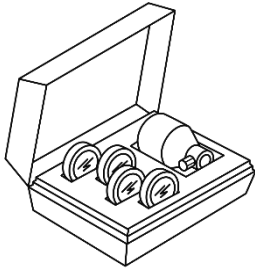

P/N: 158.200

Daylight & Halogen Filter



P/N: 158.211 | 158.207

Analyzer



P/N: 158.505 | 158.510

Polarizing filter for Transmitted Light Stage

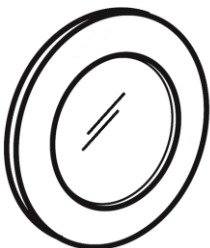

P/N: 158.500

Polarizing filter for Annular Ring Light

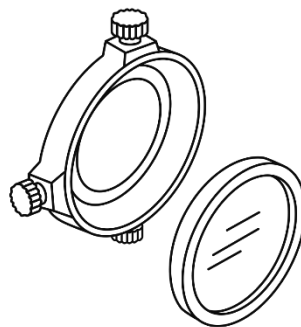

P/N: 158.430

Polarization Filter for Focusing Lens



P/N: 158.205 | 158.206

Pictures are provided for illustration purposes only, and may not provide an accurate reflection of the actual product.

По вопросам продаж и поддержки обращайтесь:

Алматы (727)345-47-04
Ангарск (3955)60-70-56
Архангельск (8182)63-90-72
Астрахань (8512)99-46-04
Барнаул (3852)73-04-60
Белгород (4722)40-23-64
Благовещенск (4162)22-76-07
Брянск (4832)59-03-52
Владивосток (423)249-28-31
Владикавказ (8672)28-90-48
Владимир (4922)49-43-18
Волгоград (844)278-03-48
Вологда (8172)26-41-59
Воронеж (473)204-51-73
Екатеринбург (343)384-55-89

Иваново (4932)77-34-06
Ижевск (3412)26-03-58
Иркутск (395)279-98-46
Казань (843)206-01-48
Калининград (4012)72-03-81
Калуга (4842)92-23-67
Кемерово (3842)65-04-62
Киров (8332)68-02-04
Коломна (4966)23-41-49
Кострома (4942)77-07-48
Краснодар (861)203-40-90
Красноярск (391)204-63-61
Курск (4712)77-13-04
Курган (3522)50-90-47
Липецк (4742)52-20-81

Магнитогорск (3519)55-03-13
Москва (495)268-04-70
Мурманск (8152)59-64-93
Набережные Челны (8552)20-53-41
Нижний Новгород (831)429-08-12
Новокузнецк (3843)20-46-81
Ноябрьск (3496)41-32-12
Новосибирск (383)227-86-73
Омск (3812)21-46-40
Орел (4862)44-53-42
Оренбург (3532)37-68-04
Пенза (8412)22-31-16
Петрозаводск (8142)55-98-37
Псков (8112)59-10-37
Пермь (342)205-81-47

Ростов-на-Дону (863)308-18-15
Рязань (4912)46-61-64
Самара (846)206-03-16
Санкт-Петербург (812)309-46-40
Саратов (845)249-38-78
Севастополь (8692)22-31-93
Саранск (8342)22-96-24
Симферополь (3652)67-13-56
Смоленск (4812)29-41-54
Сочи (862)225-72-31
Ставрополь (8652)20-65-13
Сургут (3462)77-98-35
Сыктывкар (8212)25-95-17
Тамбов (4752)50-40-97
Тверь (4822)63-31-35

Тольятти (8482)63-91-07
Томск (3822)98-41-53
Тула (4872)33-79-87
Тюмень (3452)66-21-18
Ульяновск (8422)24-23-59
Улан-Удэ (3012)59-97-51
Уфа (347)229-48-12
Хабаровск (4212)92-98-04
Чебоксары (8352)28-53-07
Челябинск (351)202-03-61
Череповец (8202)49-02-64
Чита (3022)38-34-83
Якутск (4112)23-90-97
Ярославль (4852)69-52-93

Россия +7(495)268-04-70

Казахстан +(727)345-47-04

Беларусь +(375)257-127-884

Узбекистан +998(71)205-18-59

Киргизия +996(312)96-26-47

эл.почта: sqh@nt-rt.ru || сайт: <https://schott.nt-rt.ru/>